

# Installation

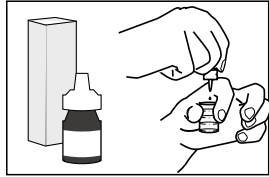

1. Determining the local water quality / carbonate hardness.

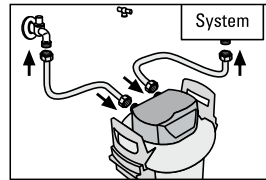

2. Fit hoses to the inlet and outlet of the pressure vessel lid.

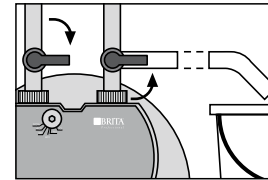

3. Close inlet valve.  
**Open flush valve and leave open.**  
4. Check the by-pass setting according to the identified carbonate hardness.

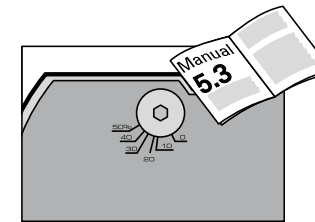

5. Setting of determined bypass.

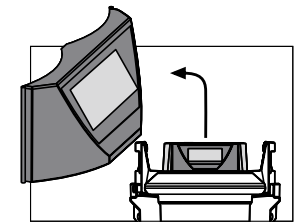

6. Pull of the display unit to the front.  
**Note:** the digital display will be delivered in stand-by mode

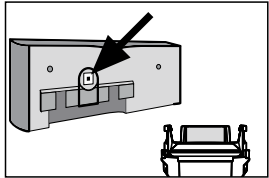

7. The display unit is operated using a button on the back of it. By pushing the button the display will turn on.

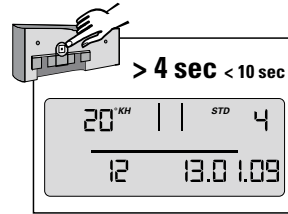

8. For setting the parameters press the button (> 4 sec, but < 10 sec).

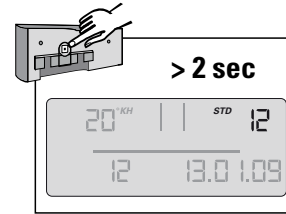

9. Keep the button pressed (>2 sec) until the value for the filter system and size flashes.

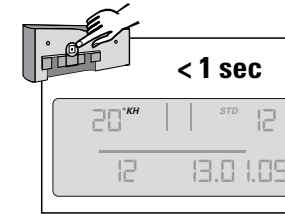

10. Briefly press the button to get to the water hardness setting.

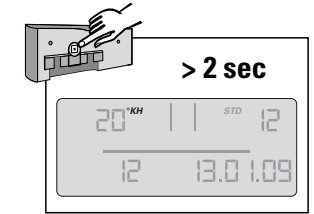

11. Keep the button pressed (>2 sec) until the requested water hardness appears.

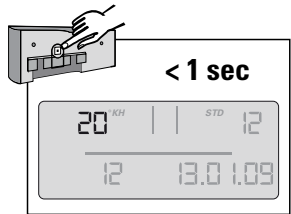

12. Briefly press the button to get to the hardness value setting.

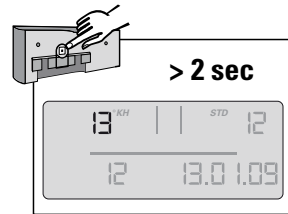

13. Keep the button pressed (>2 sec) until the determined value is reached.

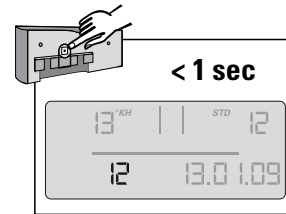

14. Briefly press the button to get to the month limit setting.

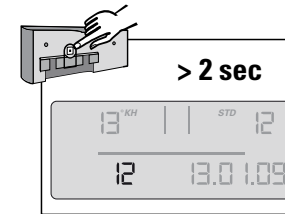

15. Keep the button pressed (> 2 sec) until the desired month value shows.

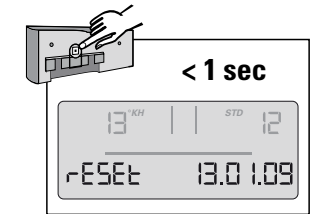

16. Briefly press the button to get to mode "accepting parameters".

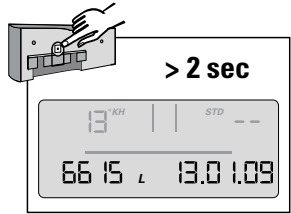

17. Keep the button pressed (> 2 sec) to accept the set parameters.

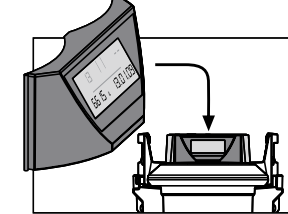

18. Re-insert display unit.

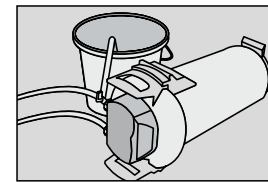

19. Flushing / bleeding of filter system.  
**Position filter horizontally.**  
**Note:** PURITY 600 and 1200 Quell GY only vertically!

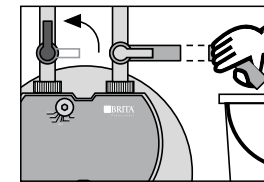

20. Completely open flush valve. Open the inlet valve at inlet hose while holding the flush hose in the bucket.  
**Flush quantity at least 10 l.** Close flush valve.

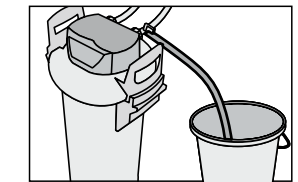

21. Position filter **vertically**. Open flush valve again and repeat flushing. Flush quantity once again **at least 10 l.**

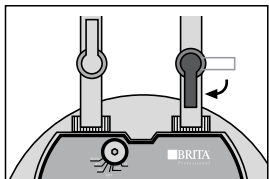

22. Close flush valve.

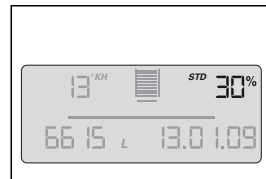

23. When by-pass setting in percent is shown in the display filter system is ready to operate. If not, the filter system must be flushed again.

## Legend (1)

STD 4 = PURITY 450 Quell ST  
STD 6 = PURITY 600 Quell ST  
STD 12 = PURITY 1200 Quell ST  
STM 4 = PURITY 450 Steam  
STM 6 = PURITY 600 Steam  
STM 12 = PURITY 1200 Steam  
GYP 6 = PURITY 600 Quell GY  
GYP 12 = PURITY 1200 Quell GY

## Legend (2):

° KH = german carbonate hardness  
° EH = english carbonate hardness  
° FH = french carbonate hardness  
° DH = german total hardness  
gpg = US american hardness  
mg/L = international hardness

## QuickFit Guide

**PURITY**  
Quell ST · Quell GY · Steam

www.brita.net

# Cartridge exchange

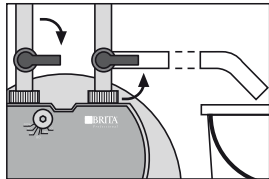

1. Close inlet valve. Remove pressure from the system by opening flush valve and leave it open.

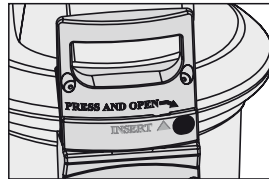

2. Remove pressure vessel lid.

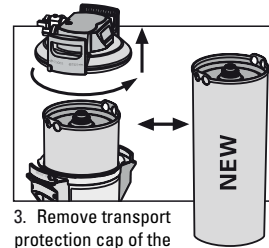

3. Remove transport protection cap of the new cartridge and place the cartridge in the pressure vessel.

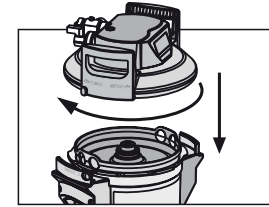

4. Put the pressure vessel lid back.

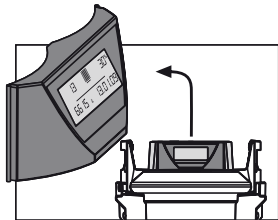

5. Pull off the display unit to the front.

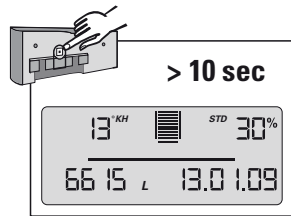

6. By pressing the button (> 10 sec), the data set on initial installation will be accepted again, and the capacity, by-pass setting and input date are all updated.

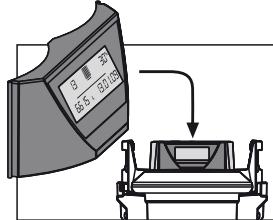

7. Insert display unit from front.

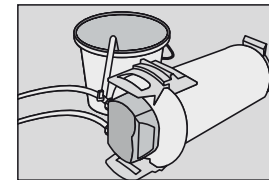

8. Flushing / bleeding of filter system  
**Position filter horizontally.**

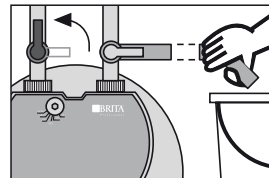

9. Completely open flush valve. Open the inlet valve at inlet hose while holding the flush hose in the bucket. Flush quantity at least **10 l**. Close flush valve.

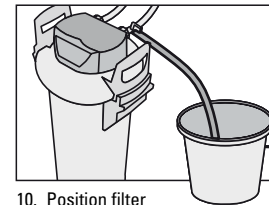

10. Position filter **vertically**. Open flush valve again and repeat flushing. Flush quantity once again at least 10 litres.

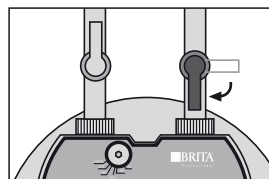

11. Close flush valve.

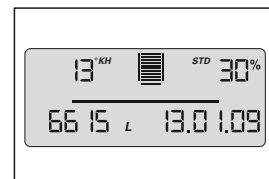

12. When bypass setting in percent is shown in the display filter system is ready to operate. If not, the filter system must be flushed again.

## QuickFit Guide

# PURITY

Quell ST · Quell GY · Steam

[www.brita.net](http://www.brita.net)

BRITA GmbH  
Heinrich-Hertz-Straße 4  
D-65232 Taunusstein  
tel: +49 (0) 61 28 / 746-765  
fax: +49 (0) 61 28 / 746-740  
professional@brita.net  
[www.professional.brita.de](http://www.professional.brita.de)

BRITA Professional  
Brita House  
9 Granville Way  
Bicester  
Oxfordshire  
OX26 4JT  
Great Britain

tel: +44 (0)844 742 4990  
fax: +44 (0)844 742 4902  
clientservices@brita.co.uk  
<http://professional.brita.co.uk>